

Player \_\_\_\_\_ HC'P

Marker \_\_\_\_\_ HC'P

HOLE	BLACK	BLUE	WHITE	INDEX	PAR	P1	P2	RESULT	P3	P4	RED	INDEX
1	352	330	318	16	4						285	14
2	179	162	162	5	3						157	7
3	349	313	307	8	4						279	8
4	500	486	452	14	5						442	11
5	186	170	137	12	3						125	16
6	391	357	339	6	4						320	6
7	377	359	315	13	4						281	9
8	524	499	460	3	5						445	3
9	351	329	316	9	4						284	12
OUT	3209	3005	2806		36						2618	

Player Sign \_\_\_\_\_ Date \_\_\_\_\_

Marker Sign \_\_\_\_\_ Tee \_\_\_\_\_

Event \_\_\_\_\_

ACR      Result

HOLE	BLACK	BLUE	WHITE	INDEX	PAR	P1	P2	RESULT	P3	P4	RED	INDEX
10	371	333	330	7	4						315	15
11	552	534	509	11	5						463	5
12	376	356	315	18	4						286	13
13	217	200	173	4	3						152	4
14	513	498	475	10	5						450	10
15	342	285	268	15	4						268	17
16	409	376	351	2	4						324	2
17	177	160	140	17	3						140	18
18	383	362	335	1	4						285	1
IN	3340	3104	2896		36						2683	
OUT	3209	3005	2806		36						2618	
TOT	6549	6109	5612		72						5301	

Gross   
 HC'P   
 Net

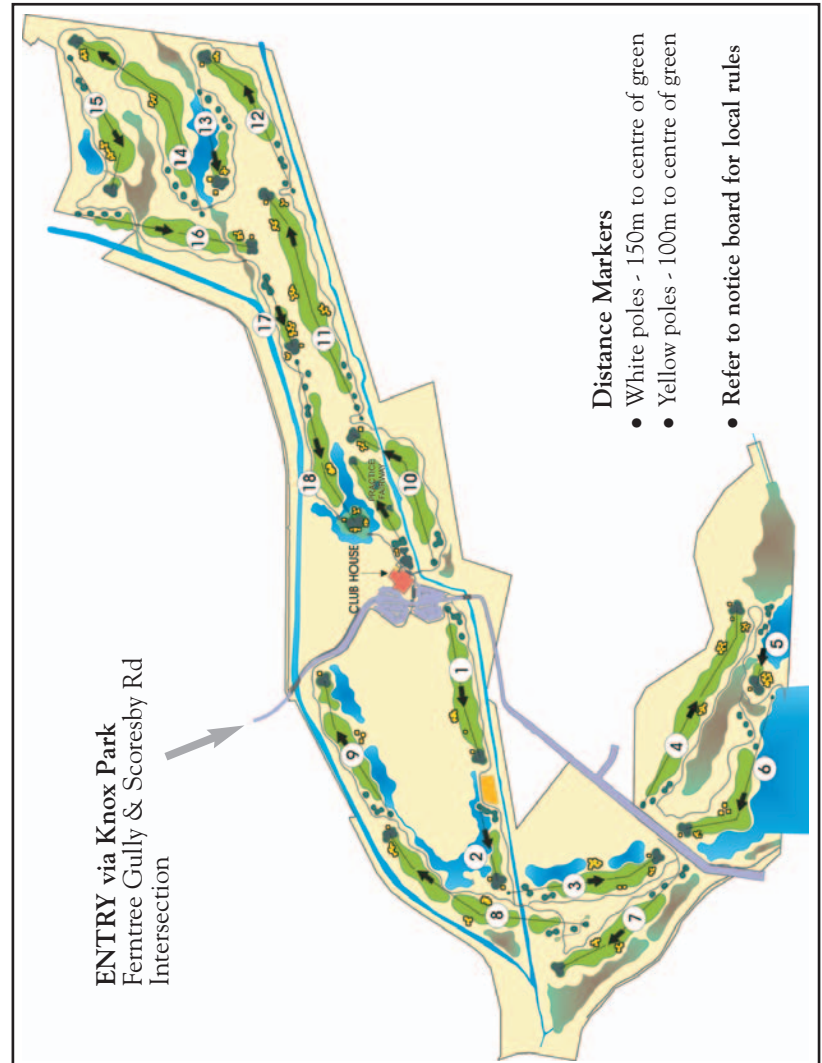

## Accepted Conditions of Play...

**The Course controller** has complete authority to ask any player to speed up or let faster groups play through. Rude, abusive or disorderly conduct is forbidden.-- any guests who does not abide by the controllers request, will be asked to leave the course immediately.

### Playing time...average 13 minutes per hole [ max 4 players per group ]

Players are expected to complete each nine [9] holes in approximately 2 hours... if not.. hold-ups may be incurred.

**Lost Balls** -If a ball is thought to be lost, a provisional ball should be played.. a maximum of **five minutes** is to be spent looking for the lost ball.

**Bunkers, greens and fairways**- please... ensure bunkers are raked on exit ..and that greens and fairways are repaired correctly.

### Dress Code and Equipment-

Each player to have their own bag and clubs, dress with a **collared shirt, tailored pants**, have **appropriate golfing footwear**... Soft spikes only.

### Electric Golf Carts--maximum 2 players per cart - drivers must be licensed...

must drive safely at all times, not within 10 metres of the greens, tees, bunkers creeks and lakes.--Karoo Road, Drivers must stop before entering either side of the Tunnel under Karoo Road..... and proceed only when "safe" to do so..

**- Drivers will be held responsible for the first \$2,500 of damage -**

**Safety notice.--** Waterford Valley Golf has adopted safe working practices under the Occupational Health, Safety and Welfare Act-- when the flag has been removed- the greens are out of play- Fairway/rough maintenance- golfers must wait for any approaching vehicle or mower to pass behind them.

**Reasonable precautions must be taken to ensure safety on the course.**

## Local Rules

**Out of bounds** White stakes. Rule 27.1 -Houses along holes 1, 2, 8, 9

Creeks on holes 1, 2, 3, 8, 9, 10, 11, 12, 16, 17, 18.

**Lateral water hazards**... All lakes and wetlands--Play from point of entry- one penalty stroke

**Staked tress & Cart paths.** 24.2b(i)... Relief must be taken, one club length, no penalty .



## waterfordvalley **golf** FUNCTION CENTRE

Phone: **9753 3200**

corporate training and conferences  
social events - weddings

Stamford Room - seats.. 20-50

Monbulk Room - seats.. 30-60

Waterford Room - seats.....200

Bunji Way, Rowville

Entry.. via Ferntree Gully & Scoresby Rd intersection

[www.wvgolf.com.au](http://www.wvgolf.com.au)

**GOLF BOOKINGS -- 9753 3200**



**waterfordvalley **golf****  
championship golf course  
public access -7days

Phone Bookings:  
**9753 3200**